

REVISION HISTORY			
REV	DESCRIPTION	DATE	BY
A	RELEASED	10/3/2005	RM

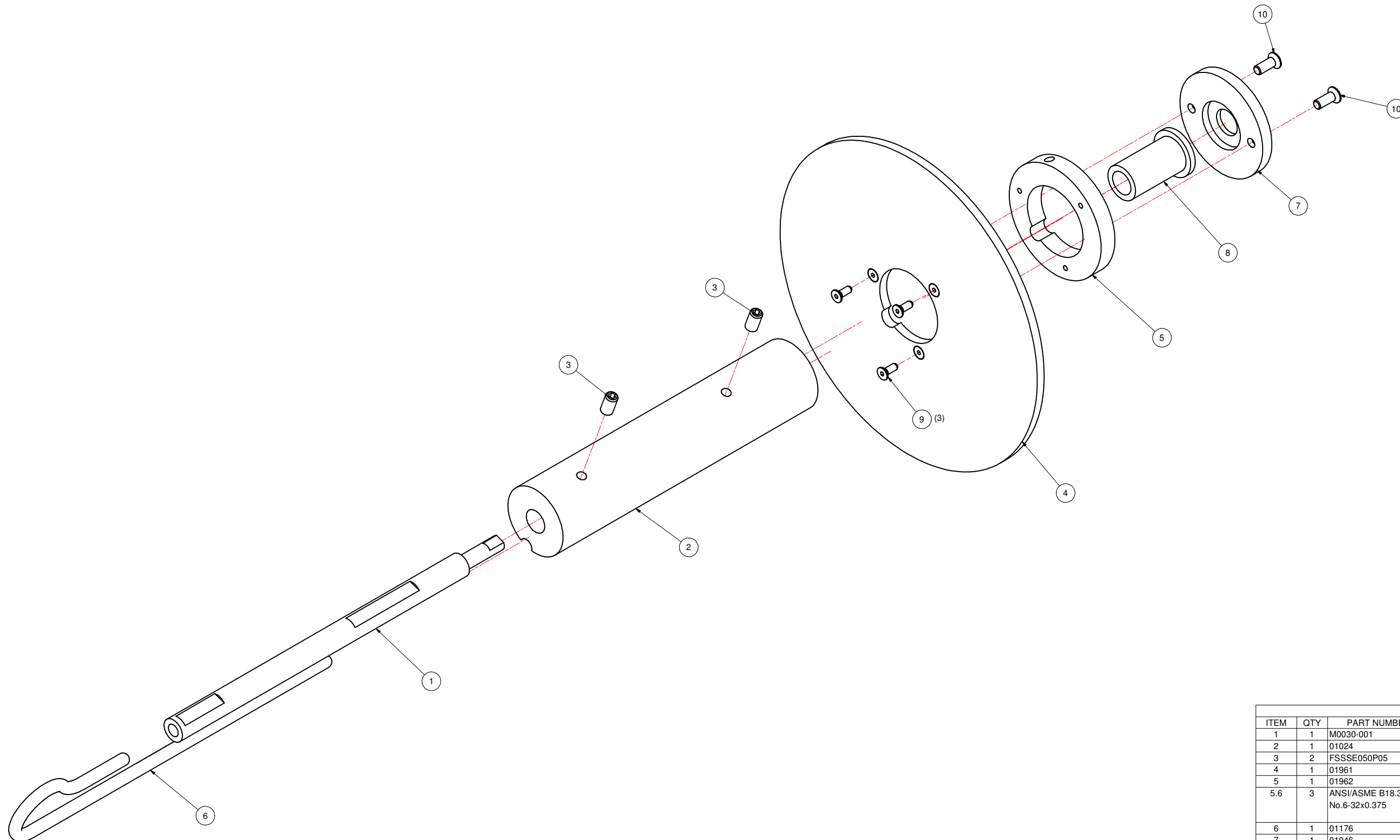

Parts List			
ITEM	QTY	PART NUMBER	DESCRIPTION
1	1	M0030-001	901-6" STD. REWIND SHAFT
2	1	01024	901 STD. HEAD 6" REWIND ROLL
3	2	FSSSE050P05	1/4-20 X 1/2 SET SCREW
4	1	01961	7" REWIND DISC
5	1	01962	REWIND DISC HUB
5.6	3	ANSI/ASME B18.3 No. 6-32x0.375	No. 6-32x0.375 Hexagon Socket Flat Countersunk Head Cap Type ANSI/ASME B18.3
6	1	01176	TAPE RELEASE PIN
7	1	01046	REWIND SPINDLE BUSHING CAP

MATL	PART #	CAD FILE	REWIND DISK ASSY	TOLERANCES	STAINLESS	LOVESHAW	REWIND DISK ASSY
	STD	PLOT DATE	10/3/2005	OTHER	FHSAD7B08	LOVESHAW	REWIND DISK ASSY
ST. ST		DRAWN DATE	10/3/2005		FHSAD7B08	LOVESHAW	REWIND DISK ASSY
STAINLESS - NO FINISH		DO NOT SCALE PRINT		X=±1.0mm MACH. 127		DWG NO REWIND DISK ASSY SCALE	
				METRIC XX=±1.0mm FINISH 127		MATERIAL CHECKED	
				XXX=±1.005		DRAWN RICHM APPROVED	
				ANGLES ±1/2°			
				FRACTIONS ±1/64			

THIS DRAWING AND SUBJECT MATTER THEREON IS THE EXCLUSIVE PROPERTY OF LOVESHAW ITW AND IS TO BE TREATED BY YOU AS CONFIDENTIAL PROPRIETARY INFORMATION. THIS DRAWING OR SUBJECT MATTER THEREOF SHALL NOT BE REPRODUCED OTHER THAN FOR YOUR OWN USE OR TO BE DISCLOSED TO OTHER WITHOUT THE EXPRESSED WRITTEN CONSENT OF LOVESHAW ITW AND WILL BE RETURNED TO LOVESHAW ITW UPON REQUEST.