

REVISION HISTORY			
REV	DESCRIPTION	DATE	BY
A	RELEASED	9/26/2005	RM

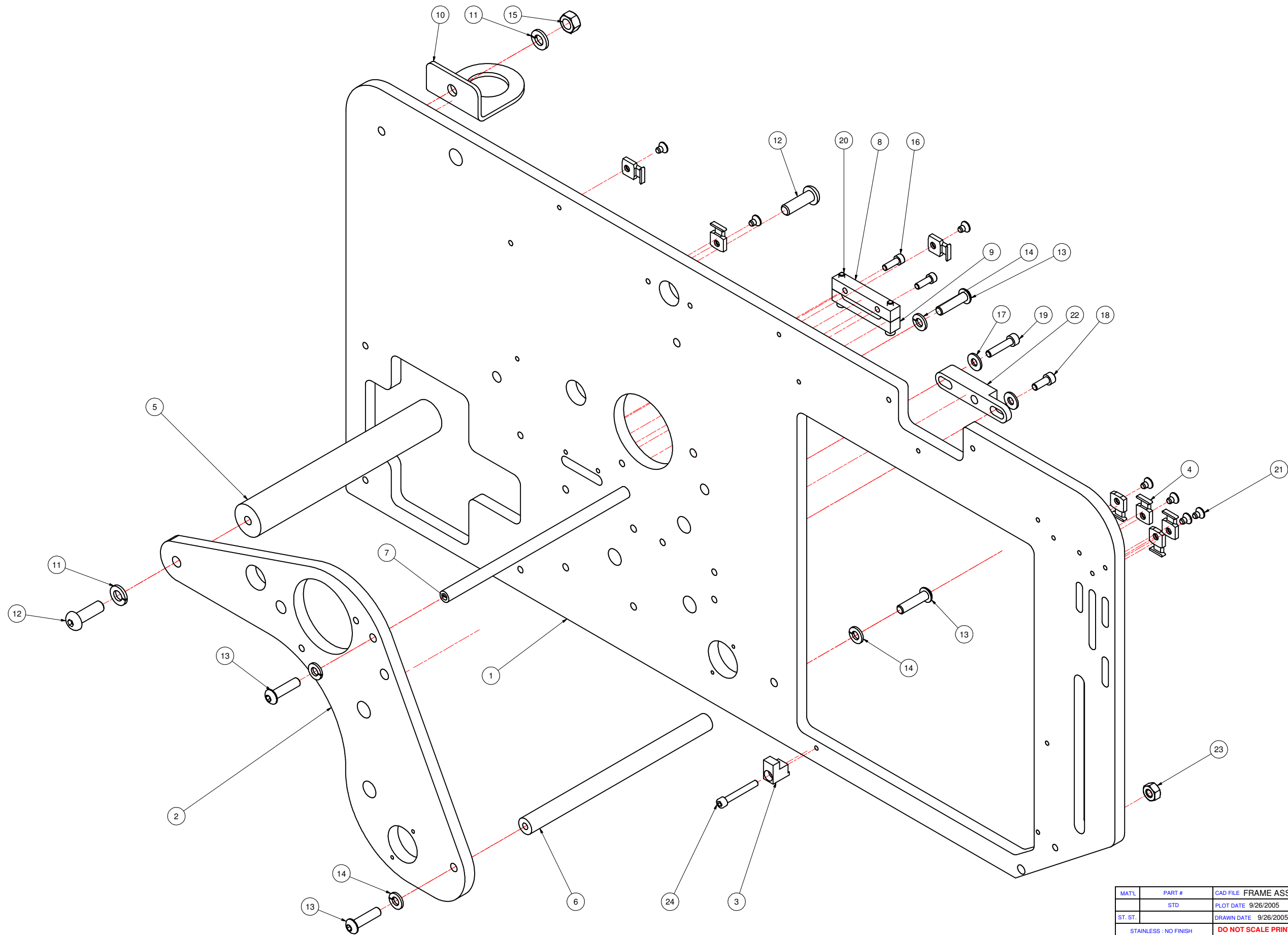

Parts List			
ITEM	QTY	PART NUMBER	DESCRIPTION
1	1	B0080-001	LARGE FRAME PLATE 908
2	1	B0080-002	SMALL FRAME PLATE
3	1	M0105-112	PRINTER CLAMP
4	7	14816	HOLD DOWN
5	1	01040-7	POST LABELING HEAD
6	1	M0010-017	IDLER ROLLER SHAFT
7	1	13012	IDLER SHAFT
8	1	M0100-051	STRAIN RELIEF FIXED BAR
9	1	M0100-052	STRAIN RELIEF CLAMP BAR
10	1	14060	FILTER REGULATOR MOUNT
11	3	FLWSEP	LOCK WASHER 5/16
12	2	FBHSH100P05	5/16-18 X 1 BHCS
13	4	FBHSE100P05	1/4-20 X 1 BHCS
14	4	FLWSDP	LOCK WASHER 1/4
15	1	FHFNSHS	5/16 X 18 HEX NUT
16	2	FSHSB050B08	8-32 X 1/2 SHCS
17	2	FFWSCP	#10 FLAT WASHER
18	1	FSHSD050P05	10-32 X 1/2 SHCS
19	1	FSHSD087P05	10-32 X 7/8 SHCS
20	2	FSHSB087P08	8-32 X 7/8 SHCS
21	7	FFHSB025P08	8-32 X 1/4 FHS
22	1	01460	IDLER SPROCKET MOUNT
23	1	FHFNSEP	HEX NUT 1/4-20
24	1	FSHSB125P08	8-32 X 1 1/4 SHCS

MATL	PART #	CAD FILE	FRAME ASSY.dwg	TOLERANCES UNLESS OTHERWISE NOTED:	<b>LOVESHAW</b> an <i>ITW</i> Company RT. 296, SOUTH CANAAN, PA.
ST. ST.	STD	PLOT DATE	9/26/2005	X = ±1.050 INCH XX = ±1.015 ANGLES ±1/2° .XXX = ±1.005	
STAINLESS - NO FINISH		DO NOT SCALE PRINT		X = ±1.0mm MACH. FINISH METRIC XX = ±1.3mm .XXX = ±1.1mm	TITLE <b>FRAME ASSEMBLY</b>
THIS DRAWING AND SUBJECT MATTER THEREON IS THE EXCLUSIVE PROPERTY OF LOVESHAW ITW AND IS TO BE TREATED BY YOU AS CONFIDENTIAL PROPRIETARY INFORMATION. THIS DRAWING OR SUBJECT MATTER THEREOF SHALL NOT BE REPRODUCED OTHER THAN FOR YOUR OWN USE OR TO BE DISCLOSED TO OTHER WITHOUT THE EXPRESSED WRITTEN CONSENT OF LOVESHAW ITW AND WILL BE RETURNED TO LOVESHAW ITW UPON REQUEST.				DWG NO FRAME ASSY	SCALE 3/4:1
				FRACTIONS ±1/64	MATERIAL DRAWN RICHM CHECKED APPROVED